

RICS
Certified
Property
Measurer
Floor plan produced in accordance with RICS Property Measurement Standards (IPMS2 Residential). © ndscom 2022.
Produced for Gibson Lane. REF: 903196

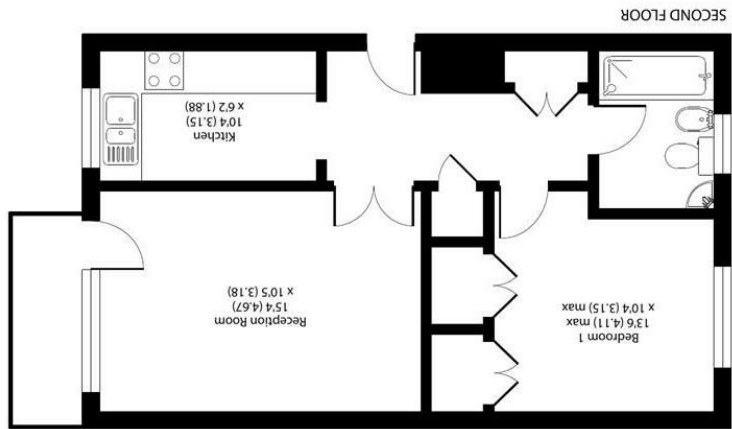

Total = 495 sq ft / 45.9 sq m
For identification only - Not to scale

34 Richmond Road
Kingston upon Thames
Surrey
KT2 5ED
www.gibsonlane.co.uk
Tel: 020 8546 5444

gibson lane



Deer Park Close,
Kingston Upon Thames, Surrey, KT2 7RH

- Spacious 1 Bedroom Top Floor Flat
- Fully Fitted Kitchen
- Good Size Reception Room
- Private Balcony
- Communal Gardens
- Close To Richmond Park
- Unfurnished
- Council Tax Band - C
- EPC Rating- D



£1,500 Per Calendar Month

Deer Park Close,
Kingston Upon Thames,
Surrey,
KT2 7RH



Description:

Gibson Lane proudly present to the market a top floor one bedroom apartment with balcony located close to Richmond Park, Norbiton Station and Kingston Town Centre. The property is presented to a good standard internally and features a separate kitchen, double bedroom and spacious bathroom. Further benefits include balcony off the lounge and communal gardens.

Location:

Hillside Court is situated in this highly sought after North Kingston location convenient for Richmond Park, Norbiton station and the A3 which serves both London & the M25. Kingston town centre with its array of shops, restaurants and bars is a short distance away.

Furnishing: Unfurnished
Local Authority: Kingston upon Thames
Council Tax Band: C
Available Date:
Deposit: £1,730
Tenancy Term: Long Term

